

PLAN
of the Land of
WAIALAE IKI

IN
OAHU
the property of
A. PAKI
1851

Scale 1 in = 600 ft.

Traced from Bishop Estate Reg. Map No. 58.

H.E. Newton, May, 1906.

LCA 10613 Part 3 to A. Paki

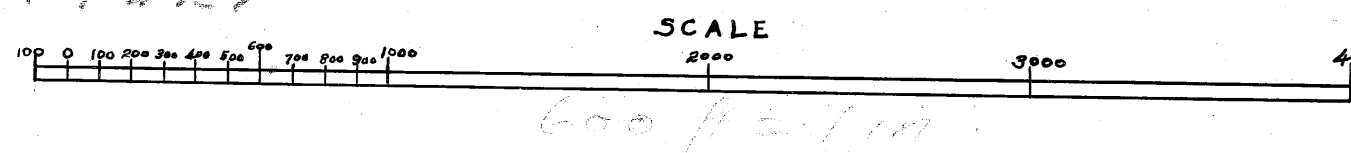

Enlarged Plan of the boundary
through the Kalo Land
Scale 1 in. = 300 ft.

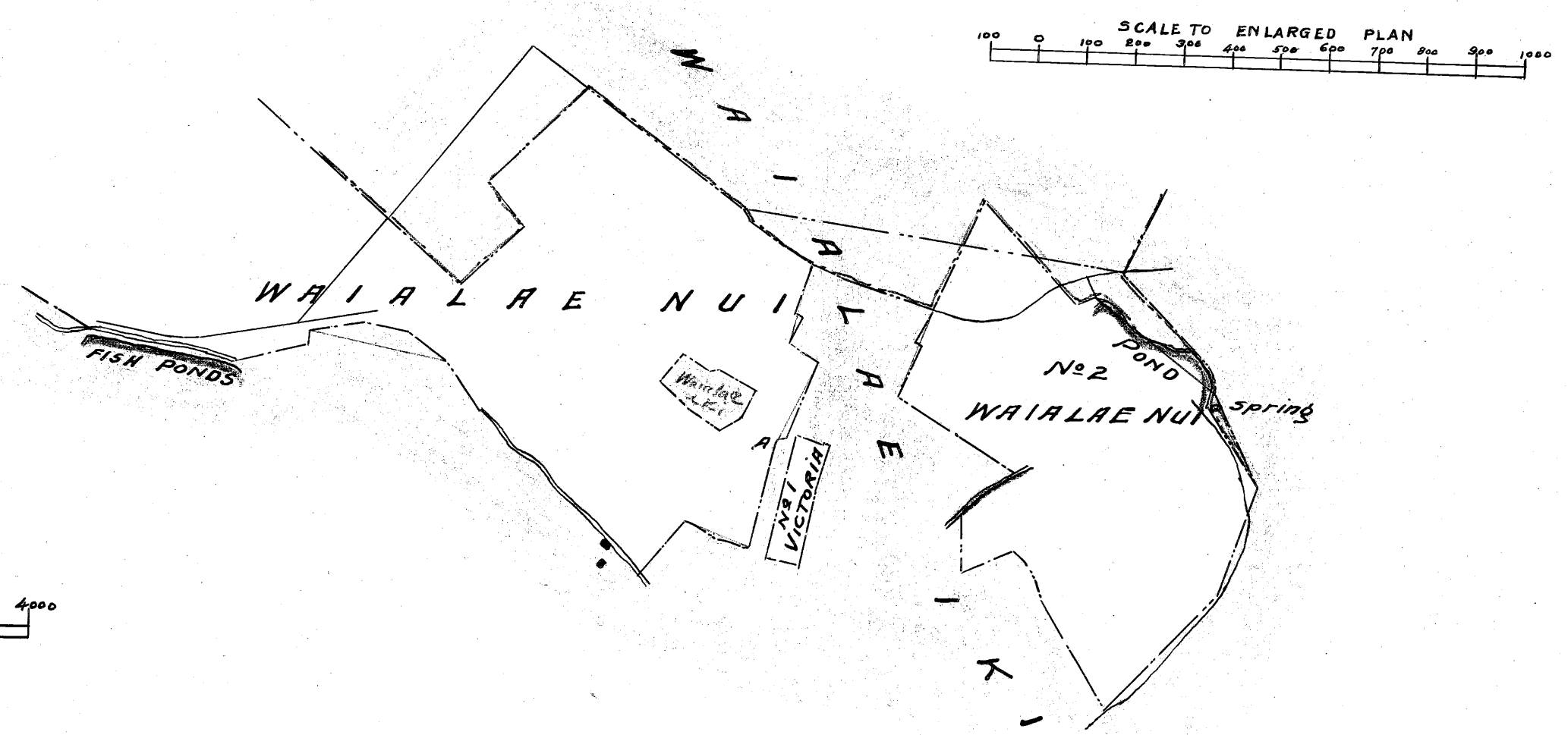

Note: 6th September 1852. The red shaded line shows the boundary between Waialaeiki and Waialaenui as agreed to between M. Kekuanooa and C.R. Bishop in the settlement of the disputed boundary W-W

Note: The Red lines on the boundary are bearings referred to in description & the boundary of the land claimed by Victoria is shown with a blue dotted line.

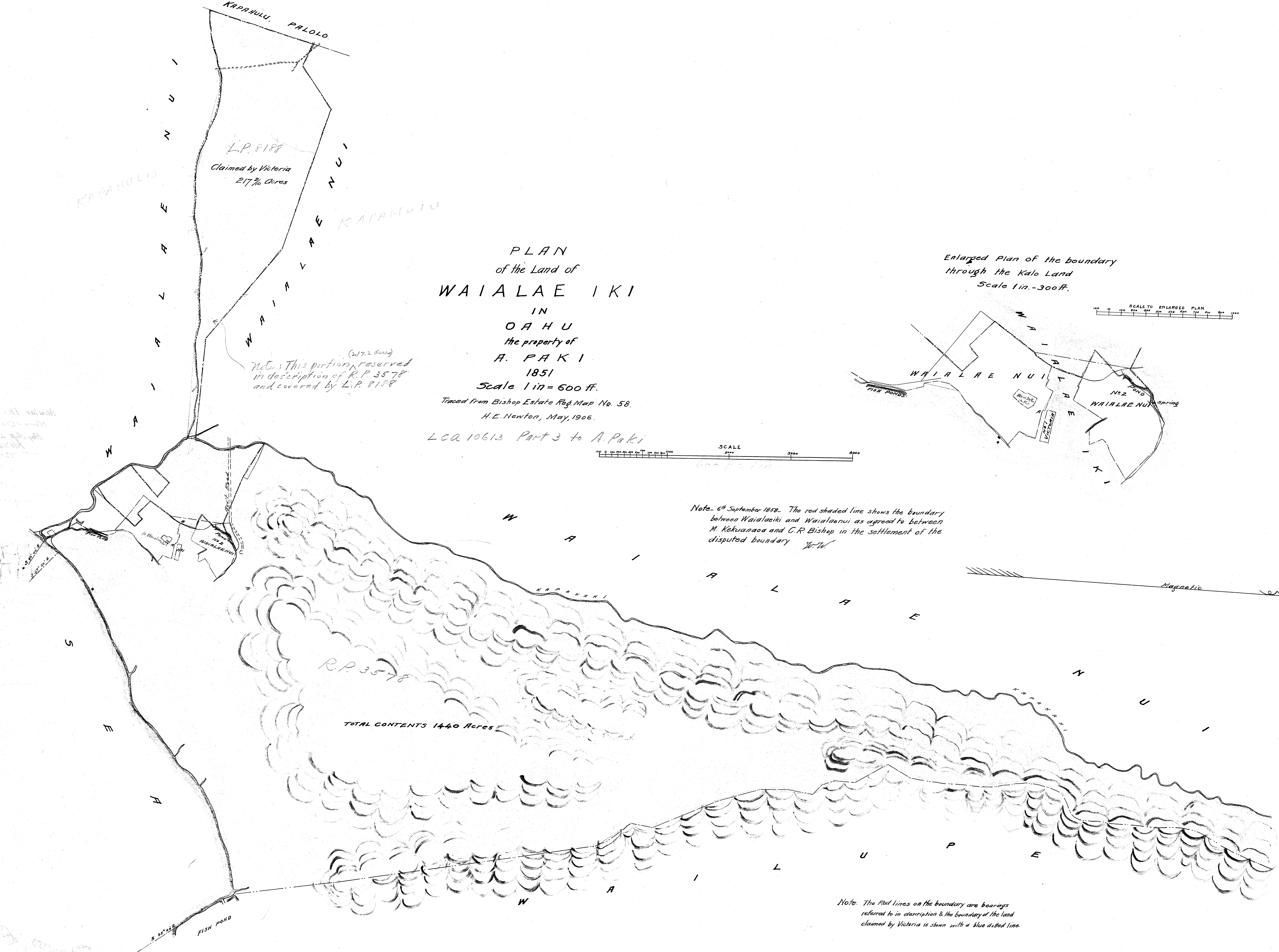

L.P. 8188
Claimed by Victoria
217 1/2 Acres

Note: This portion reserved in description of R.P. 3578 and covered by L.P. 8188

R.P. 3578

TOTAL CONTENTS 1440 Acres

Handwritten notes on the left margin.

Handwritten notes on the right margin.

Handwritten signature or date at the bottom right.