

L. 774
D. Bishop
July 1892

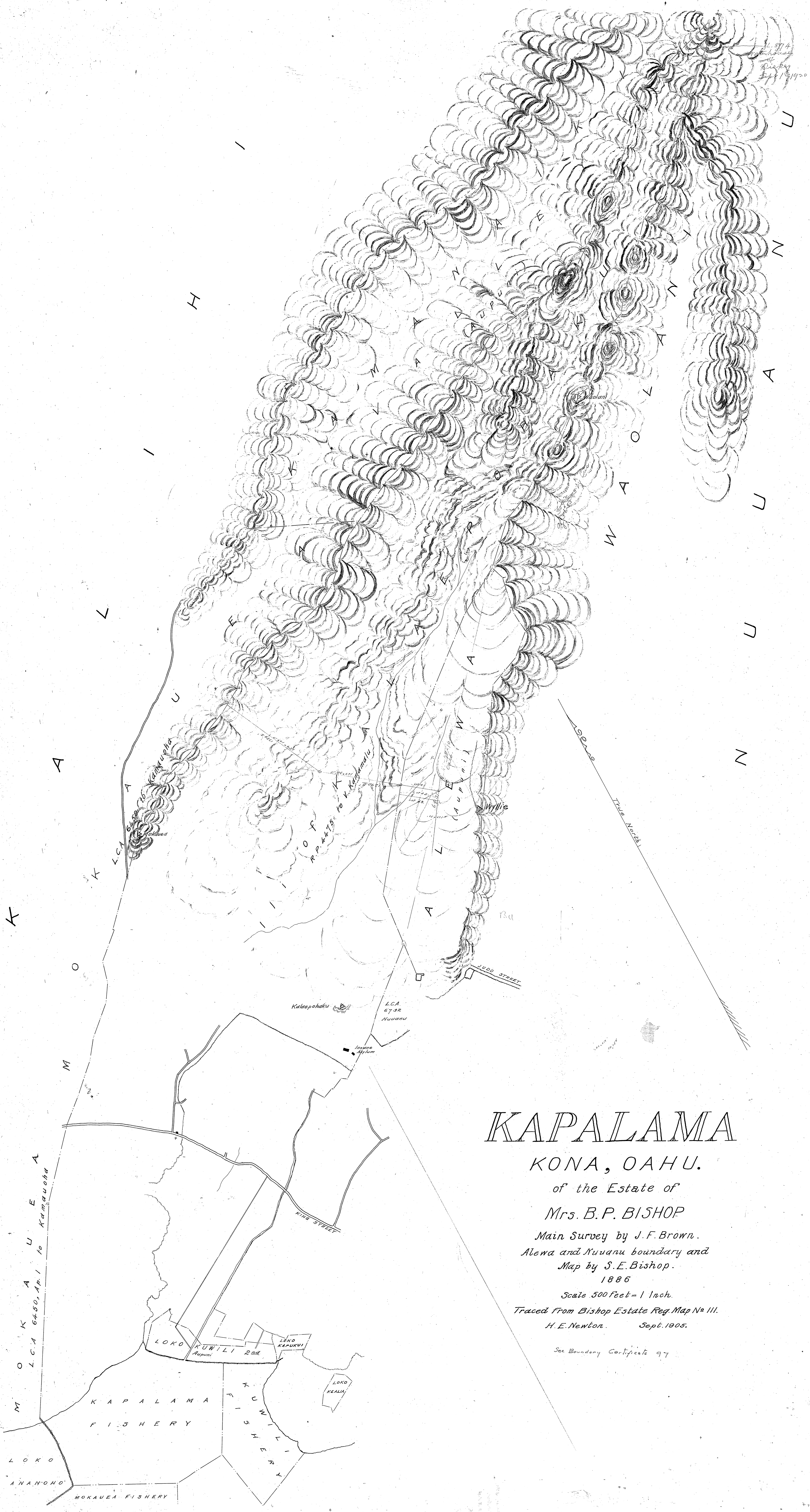

KAPALAMA

KONA, OAHU.

of the Estate of
Mrs. B.P. BISHOP

Main Survey by J.F. Brown.
Alewa and Nuuanu boundary and
Map by S.E. Bishop.
1886

Scale 500 Feet = 1 Inch.

Traced from Bishop Estate Reg. Map No. 111.
H.E. Newton. Sept. 1905.

See Boundary Certificate 97